

Benchmark B Series Vane Pumps & Motors

Versatile, Durable and Dependable



High Performance Interchange Vane Pumps & Motors

Genuine Benchmark B Series vane pumps and motors are available in a variety of configurations and displacements. Our vane pumps come in four basic frame sizes: single, double, triple and drive train configurations, with pressures up to 4350 psi and maximum rpms up to 3000 in a single pump.

Our line of B Series vane motors are available with reversible shaft rotation and a variety of torque ratings and port locations. These are rated for pressures up to 2500 psi and maximum rpms up to 4000. The B Series is engineered for reliable use with a long service life for many applications and is capable of accommodating a wide range of fluid viscosities. These units are replacements for Parker®/Denison® T6, T7 & M4 series vane units.

- Single, Double, Triple & Drive Train options
- High pressure efficiency
- Cartridge Kit design - replacement Cartridge Kits available
- Drop-in assemblies, easy conversion, and ease of maintenance
- Engineered for a wide speed range
- Balanced design allows for extended bearing life
- Low noise level design
- Wide range of acceptable viscosities
- High pressure efficiency with special fluids such as phosphate esters and water glycols
- Great mounting flexibility and installation compatibility
- Form, fit and function replacements for Parker®/Denison® T6, T7 & M4 units



Reliable, No Matter the Application

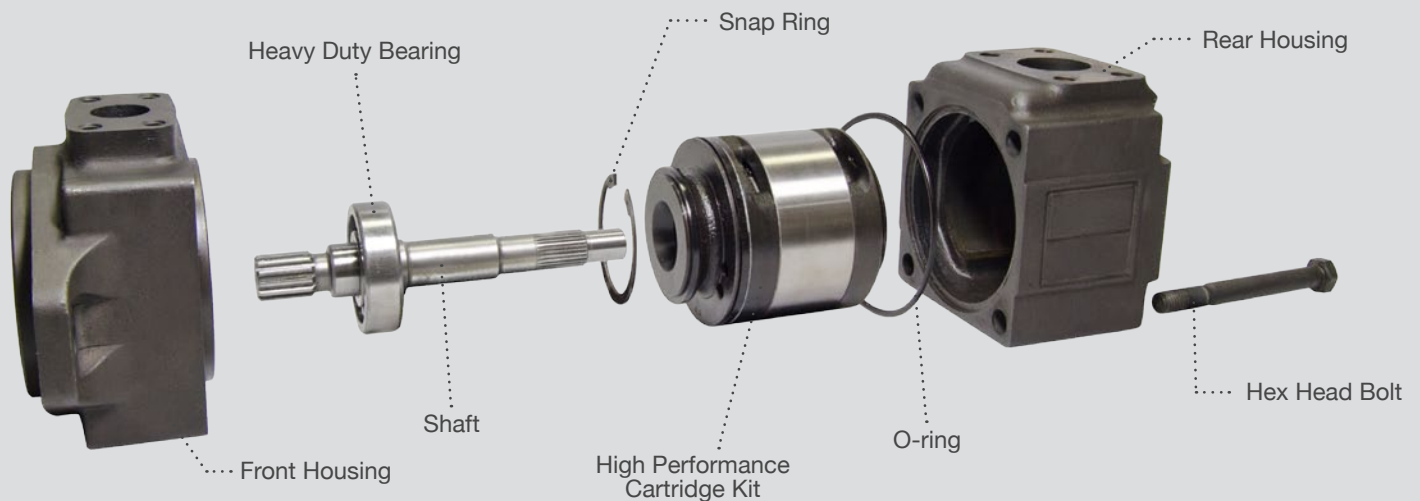

SINGLE PUMPS

PUMP SERIES	DISPLACEMENT		MAX RPM	MAX PRESSURE (PSI / BAR)
	(IN ³ /R)	(CM ³ /R)		
BT6C	0.66 - 6.10	11 - 100	2800	4000 / 275
BT6CM	0.66 - 6.10	11 - 100	2800	4000 / 275
BT6D	2.90 - 11.62	48 - 190	2500	3500 / 240
BT6DM	2.90 - 11.62	48 - 190	2500	3500 / 240
BT6E	8.07 - 16.40	132 - 270	2200	3500 / 240
BT6EM	8.07 - 16.40	132 - 270	2200	3500 / 240
BT7D	2.68 - 9.64	44 - 158	3000	4350 / 300
BT7E	8.07 - 16.40	132 - 270	2200	3500 / 240



DRIVE TRAIN PUMPS

PUMP SERIES	DISPLACEMENT		MAX RPM	MAX PRESSURE (PSI / BAR)
	(IN ³ /R)	(CM ³ /R)		
BT6CR	0.66 - 6.10	11 - 100	2800	4000 / 275
BT6CRM	0.66 - 6.10	11 - 100	2800	4000 / 275
BT6DR	2.90 - 11.65	48 - 190	3500	3500 / 240
BT6DRM	2.90 - 11.65	48 - 190	3500	3500 / 240
BT6ER	8.07 - 16.40	132 - 270	2200	3500 / 240
BT6ERM	8.07 - 16.40	132 - 270	2200	3500 / 240



DOUBLE PUMPS

PUMP SERIES	DISPLACEMENT		MAX RPM	MAX PRESSURE (PSI / BAR)
	(IN ³ /R)	(CM ³ /R)		
BT6CC	1.32 - 12.20	22 - 200	2800	4000 / 275
BT6CCM	1.32 - 12.20	22 - 200	2800	4000 / 275
BT6DC	3.56 - 17.75	59 - 290	2500	4000 / 275
BT6DCM	3.56 - 17.75	59 - 290	2500	4000 / 275
BT6EC	8.73 - 22.56	143 - 370	2200	4000 / 275
BT6ECM	8.73 - 22.56	143 - 370	2200	4000 / 275
BT6ED	11.0 - 28.06	180 - 460	2200	3500 / 240
BT6EDM	11.0 - 28.06	180 - 460	2200	3500 / 240
BT6EE	16.1 - 32.8	264 - 540	2200	3500 / 240
BT67DC	2.68 - 9.64	44 - 156	2200	4000 / 275
BT67EC	8.73 - 22.5	143 - 370	2200	4000 / 275



TRIPLE PUMPS

PUMP SERIES	DISPLACEMENT		MAX RPM	MAX PRESSURE (PSI / BAR)
	(IN ³ /R)	(CM ³ /R)		
BT6DCC	4.22 - 23.94	70 - 390	2500	4000 / 275
BT6DCCM	4.22 - 23.94	70 - 390	2500	4000 / 275



VANE MOTORS

PUMP SERIES	DISPLACEMENT		TORQUE		MAX RPM	MAX PRESSURE (PSI / BAR)
	(IN ³ /R)	(CM ³ /R)	(LB-IN/PSI)	(NM/BAR)		
BM4C	1.49 - 4.89	24 - 80	0.24 - 0.78	0.39 - 1.27	4000	2500 / 175
BM4C1	1.49 - 4.89	24 - 80	0.24 - 0.78	0.39 - 1.27	4000	2500 / 175
BM4D	3.97 - 8.81	65 - 144	0.63 - 1.40	1.04 - 2.30	4000	2500 / 175
BM4D1	3.97 - 8.81	65 - 144	0.63 - 1.40	1.04 - 2.30	4000	2500 / 175

Hydraulex - A Recognized Global Leading Provider of High Quality Hydraulic Components



Products We Offer

- Inline Piston Pumps
- Radial Piston Pumps & Motors
- Bent Axis Piston Pumps & Motors
- Fixed Volume Vane Pumps
- Variable Volume Vane Pumps
- Gear Pumps
- Vane Motors
- Axial Piston Motors
- High Speed Motors
- Servo Motors
- Orbital Motors
- Directional Valves
- Flow Control Valves
- Pressure Control Valves
- Relief Valves
- Check Valves
- Stack Valves
- Servo Valves
- Proportional Valves
- PTOs (Power Take-offs)
- Cylinders



Hydraulex Corporate
48175 Gratiot Ave
Chesterfield, MI 48051
Toll Free: 800.422.4279
Tel: 586.949.4240

www.hydraulex.com

Hydraulex Global - Michigan	Tel: 586.949.4240
Hydraulex Global - Mississippi	Tel: 601.469.1987
Hydraulex Global - ON, Canada	Tel: 416.638.6000
Hydraulex Global - Washington	Tel: 253.604.0400
Hydraulex Global - Tennessee	Tel: 901.794.2462

sales@ahx1.com
sales@metarisusa.com
sales@metaris.com
sales@h-r-d.com
sales@flinthydrostatics.com



Connect with us:



All manufacturers names, symbols and descriptions in this document are used for reference purposes only, and it is not implied that any parts listed is the product of these manufacturers.